

**COPROD tube driver**

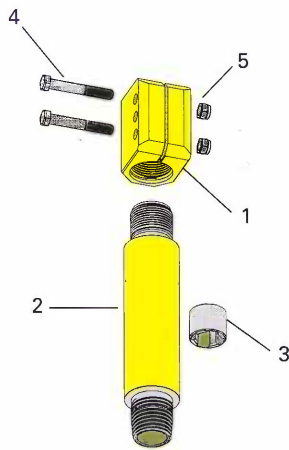

**COPROD section**

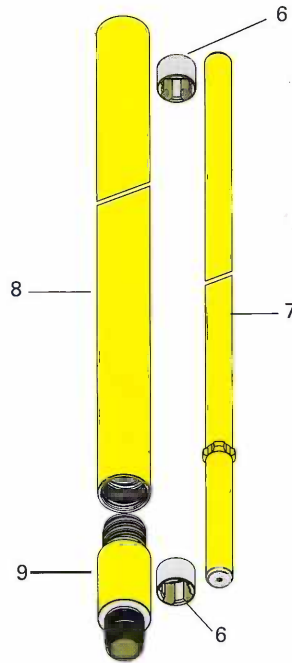

**COPROD head**

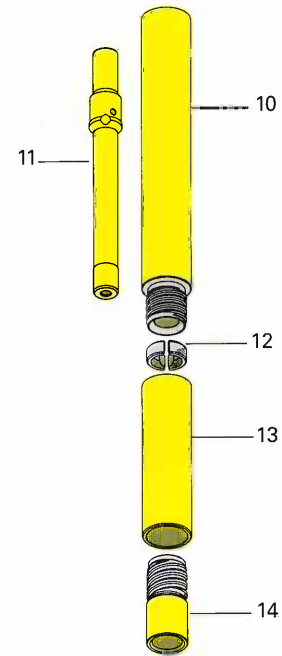

Part description	COP 1838CR,1850CR, 2150CR, 2550CR					
	COPROD 76			COPROD 89		
	Product No.	Product code	Weight *	Product No.	Product code	Weight *
<b>COPROD tube driver</b>						
1 Coupling	94800299	7970-8928-80	6.3	94800299	7970-8928-80	6.3
1 Coupling, for TED	94800300	7970-8929-80	13.7	94800300	7970-8929-80	13.7
2 Tube adapter, for TED, length 350 mm (1'1¾")	94800279	7970-7637-80	7.3	94800277	7970-8937-80	11.6
2 Tube adapter, length 350 mm (1'1¾")	94800220	7970-7635-80	7.3	94800239	7970-8946-80	11.1
2 Tube adapter, length 807 mm (2'7¾")	94800222	7970-7633-80	17.3	94800240	7970-8943-80	27.1
3 Rod guide	94800215	7970-8912-00	0.2	94800215	7970-8912-00	0.2
4 Bolt (2 pcs) M 16 x 110 (M 16 x 150 for TED)	-	-	-	-	-	-
5 Nut (2 pcs) M 16	-	-	-	-	-	-
<b>COPROD section 3.66 m (12')</b>						
6 Rod guide	94800215	7970-8912-00	0.2	94800121	7970-8902-00	0.2
7 Rod 3660 mm (12')	94800314	7970-7691-00	44	94800327	7970-8991-00	46
8 Tube 3660 mm (12')	94800315	7970-7692-80	52	94800328	7970-8992-80	66
9 End piece	94800316	7970-7693-80	4.1	94800329	7970-8993-80	6.1
<b>COPROD head</b>						
10 Bit tube	94800317	7970-7682-80	22	94800310	7970-8982-80	33
11 Bit rod	94800318	7970-7681-00	12.3	94800311	7970-8981-00	18.2
12 Stop ring	94800319	7970-7682-00	4.4	94800312	7970-8982-00	5.6
13 Bit chuck	94800235	7970-7604-00	0.2	94800128	7970-8904-00	0.2
14 Bit driver	94800320	7970-7683-00	3.8	94800298	7970-8983-00	5.8
	94800227	7970-7674-00	1.9	94800272	7970-8984-00	2.0

\* Weight approx. kg.

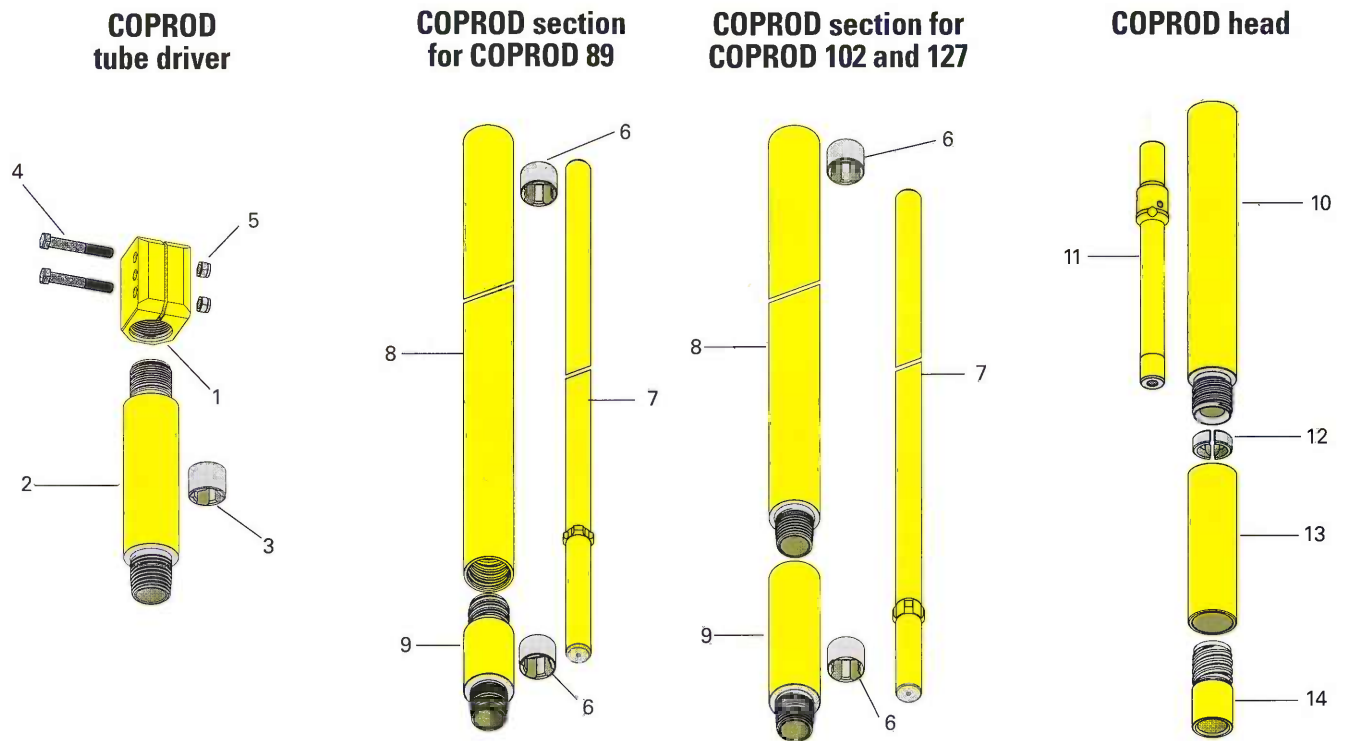

Part description	COP 4050CR								
	COPROD 89			COPROD 102			COPROD 127		
	Product No.	Product code	Weight *	Product No.	Product code	Weight *	Product No.	Product code	Weight *
<b>COPROD tube driver</b>									
1 Coupling	94800284	7970-0232-80	18.3	94800284	7970-0232-80	18.3	94800284	7970-0232-80	18.3
2 Tube adapter, L 253 mm (10")	94800241	7970-8935-80	7.8	94800243	7970-0235-80	9.5	94800245	7970-2735-80	16.9
2 Tube adapter, L 714 mm (2'4 1/8")	94800242	7970-8933-80	19.5	94800244	7970-0233-80	28.5	94800246	7970-2733-80	51.5
3 Rod guide	94800121	7970-8902-00	0.2	94800087	7970-0202-00	0.2	94800087	7970-0202-00	0.2
4 Bolt (2 pcs) M 24x160	-	-	-	-	-	-	-	-	-
5 Nut (2 pcs) M 24	-	-	-	-	-	-	-	-	-
<b>COPROD section 3.66 m (12')</b>	94800326	7970-8990-80	118	94800302	7970-0240-80	127	-	-	-
6 Rod guide	94800121	7970-8902-00	0.2	94800087	7970-0202-00	0.2	-	-	-
7 Rod 3660 mm (12')	94800327	7970-8991-00	46	94800303	7970-0241-00	56	-	-	-
8 Tube 3660 mm (12')	94800328	7970-8992-80	66	94800304	7970-0242-80	60	-	-	-
9 End piece	94800329	7970-8993-80	6.1	94800086	7970-0253-80	11	-	-	-
<b>COPROD section 6.1 m (20')</b>	94800386	7970-8955-80	190	94800083	7970-0250-80	201	94800132	7970-2750-80	225
6 Rod guide	94800121	7970-8902-00	0.2	94800087	7970-0202-00	0.2	94800087	7970-0202-00	0.2
7 Rod 6100 mm (20')	94800387	7970-8956-00	76	94800084	7970-0251-00	94	94800295	7970-2751-00	94
8 Tube 6100 mm (20')	94800388	7970-8957-80	108	94800085	7970-0252-80	96	94800133	7970-2752-80	116
9 End piece	94800329	7970-8993-80	6.1	94800086	7970-0253-80	11	94800134	7970-2753-80	15
<b>COPROD head</b>	94800310	7970-8982-80	32	94800324	7970-0282-80	47	94800362	7970-2782-80	77
10 Bit tube	94800311	7970-8981-00	18	94800323	7970-0281-00	26.1	94800363	7970-2781-00	45
11 Bit rod	94800312	7970-8982-00	5.6	94800322	7970-0282-00	10.4	94800364	7970-2785-00	16.5
12 Stop ring	94800128	7970-8904-00	0.2	94800096	7970-0204-00	0.2	94800139	7970-2704-00	0.2
13 Bit chuck	94800298	7970-8983-00	5.8	94800325	7970-0273-00	7.5	94800331	7970-2773-00	11.2
14 Bit driver	94800272	7970-8984-00	2.0	94800082	7970-0274-00	2.7	94800141	7970-2774-00	4.0

\* Weight approx. kg.

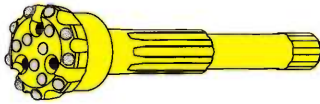

Flat front

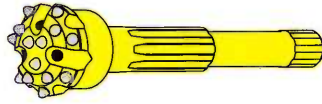

Convex front

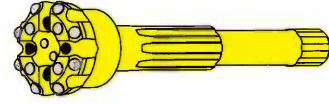

Drop center

Drill bit	Diameter		Product No.	Product code	Buttons × button diameter (mm)			Gauge buttons angle°		Flushing holes No. × size mm	Weight approx. kg
	mm	inch			Gauge outer	Gauge inner	Centre	Outer	Inner		
<b>COPROD 76 for</b>	<b>Flat front, HD, spherical</b>										
<b>COP 1838CR</b>	90	3 <sup>9</sup> / <sub>16</sub>	94800332	7976-1090-40,10-20	9×11		7×11	35°		3×8	5.8
<b>COP 1850CR</b>	95	3 <sup>3</sup> / <sub>4</sub>	94800333	7976-1095-40,10-20	9×12.7		7×11	35°		3×8	6.0
<b>COP 2150CR</b>	105	4 <sup>1</sup> / <sub>8</sub>	94800334	7976-1105-40,10-20	9×12.7		7×12.7	35°		4×10	6.4
<b>COP 2550CR</b>	<b>Convex front, ballistic</b>										
	90	3 <sup>9</sup> / <sub>16</sub>	94800335	7976-2090-66,10-20	7×12.7	4×12.7	2×12.7	40°	20°	2×10	5.6
	95	3 <sup>3</sup> / <sub>4</sub>	94800336	7976-2095-66,10-20	7×12.7	3×12.7	2×12.7	45°	30°	3×8	5.6
	105	4 <sup>1</sup> / <sub>8</sub>	94800337	7976-2105-66,10-20	9×12.7	3×12.7	4×12.7	45°	30°	3×10	6.2
	<b>Drop center, spherical</b>										
	90	3 <sup>9</sup> / <sub>16</sub>	94800338	7976-3090-40,10-20	8×13	4×11	2×11	35°		4×8	5.8
	95	3 <sup>3</sup> / <sub>4</sub>	94800339	7976-3095-40,10-20	8×11	4×11	2×11	35°		4×8	5.7
	105	4 <sup>1</sup> / <sub>8</sub>	94800340	7976-3105-40,10-20	8×12.7	4×12.7	2×11	35°		4×10	6.2
<b>COPROD 89 for</b>	<b>Flat front, HD, spherical</b>										
<b>COP 1838CR</b>	105	4 <sup>1</sup> / <sub>8</sub>	94800341	7989-1105-40,10-20	9×12.7		7×12.7	35°		3×13	9.1
<b>COP 1850CR</b>	110	4 <sup>5</sup> / <sub>16</sub>	94800342	7989-1110-40,10-20	9×14.5		6×14.5	35°		3×13	9.5
<b>COP 2150CR</b>	115	4 <sup>1</sup> / <sub>2</sub>	94800343	7989-1115-40,10-20	9×14.5		6×14.5	35°		3×13	9.7
<b>COP 2550CR</b>	127	5	94800344	7989-1127-40,10-20	9×14.5		7×14.5	35°		3×13	10.6
<b>COP 4050CR</b>	<b>Convex front, ballistic</b>										
	105	4 <sup>1</sup> / <sub>8</sub>	94800345	7989-2105-66,10-20	9×12.7	3×12.7	4×12.7	45°	30°	3×13	8.8
	110	4 <sup>5</sup> / <sub>16</sub>	94800346	7989-2110-66,10-20	9×12.7	6×12.7	4×12.7	45°	30°	3×13	9.2
	115	4 <sup>1</sup> / <sub>2</sub>	94800347	7989-2115-66,10-20	7×14.5	4×14.5	3×14.5	45°	30°	3×13	9.2
	127	5	94800348	7989-2127-66,10-20	9×14.5	6×14.5	4×14.5	45°	30°	3×13	10.1
	<b>Drop center, spherical</b>										
	105	4 <sup>1</sup> / <sub>8</sub>	94800349	7989-3105-40,10-20	8×12.7	4×12.7	2×11	35°		4×13	8.9
	115	4 <sup>1</sup> / <sub>2</sub>	94800351	7989-3115-40,10-20	8×14.5	4×14.5	2×11	35°		4×13	9.5
	127	5	94800352	7989-3127-40,10-20	8×14.5	4×14.5	4×11	35°		4×13	10.3

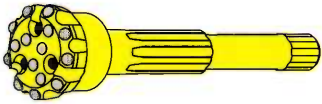

Flat front

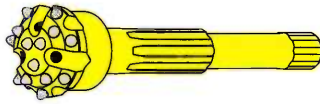

Convex front

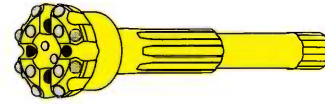

Drop center

Drill bit	Diameter		Product No.	Product code	Buttons × button diameter (mm)			Gauge buttons angle°		Flushing holes No. × size mm	Weight approx. kg
	mm	inch			Gauge outer	Gauge inner	Centre	Outer	Inner		
<b>COPROD 102 for COP 4050CR</b>	<b>Flat front, HD, spherical</b>										
	115	4½	94800353	7902-1115-40,10-20	9×14.5		6×14.5	35°		3×13	12.6
	127	5	94800354	7902-1127-40,10-20	9×14.5		7×14.5	35°		3×13	13.2
	140	5½	94800355	7902-1140-40,10-20	9×16		9×16	35°		3×13	14.5
	<b>Convex front, ballistic</b>										
	115	4½	94800356	7902-2115-66,10-20	7×14.5	4×14.5	3×14.5	45°	30°	3×13	12.2
	127	5	94800357	7902-2127-66,10-20	9×14.5	6×14.5	4×14.5	45°	30°	3×13	13.1
	140	5½	94800358	7902-2140-66,10-20	9×14.5	6×14.5	5×14.5	45°	30°	3×13	13.8
	<b>Drop center, spherical</b>										
	115	4½	94800359	7902-3115-40,10-20	8×14.5	4×14.5	2×11	35°		4×13	12.4
	127	5	94800360	7902-3127-40,10-20	8×14.5	4×14.5	4×11	35°		4×13	13.0
	140	5½	94800361	7902-3140-40,10-20	9×16	6×16	4×12.7	35°		3×13	14.5
<b>COPROD 127 for COP 4050CR</b>	<b>Flat front, HD, spherical</b>										
	140	5½	94800383	7927-1140-40,10-20	9×16		9×16	35°		3×15	21.3
	152	6	94800417	7927-1152-40,10-20	9×16		9×16	35°		3×16	23.1
	165	6½	94800384	7927-1165-40,10-20	10×16		10×16	35°		3×15	23.9
	<b>Convex front, ballistic</b>										
	152	6	94800418	7927-2152-66,10-20	9×16	6×16	4×16	45°	30°	3×16	23.1
	165	6½	94800385	7927-2165-66,10-20	9×16	6×16	6×16	45°	30°	3×15	23.1
	<b>Drop center, spherical</b>										
	165	6½	94800378	7927-3165-40,10-20	10×16	6×16	5×16	35°		2×18	23.8
	<b>Drop center, ballistic</b>										
140	5½	94800368	7927-3140-66,10-20	9×16	6×16	4×12.7	35°		3×16	20.2	