

# G-Force Nova GFNQ8000 QL80 Shank

## Hammer Service Log

### Wear Sleeve / Piston Clearance

Part	New Dimension		Discard Clearance
Wear Sleeve	A	5.93"	greater than or equal to 0.010"
Piston OD	B	5.92"	

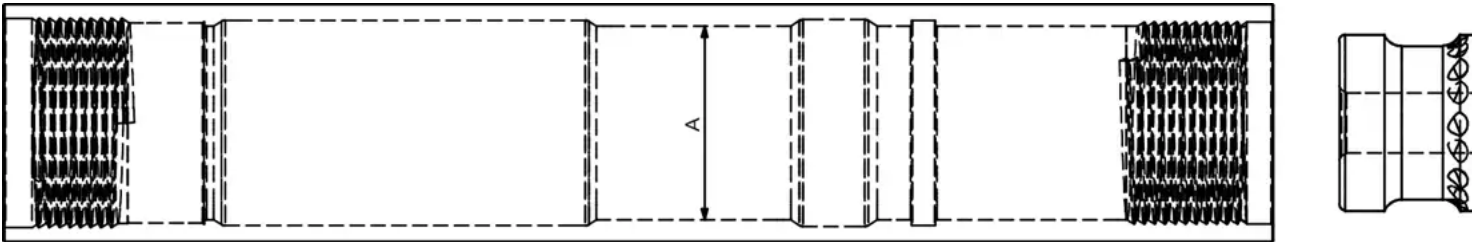

### Inner Cylinder / Piston Clearance

Part	New Dimension		Discard Clearance
Cylinder ID	C	5.39"	greater than or equal to 0.010"
Piston OD	D	5.38"	

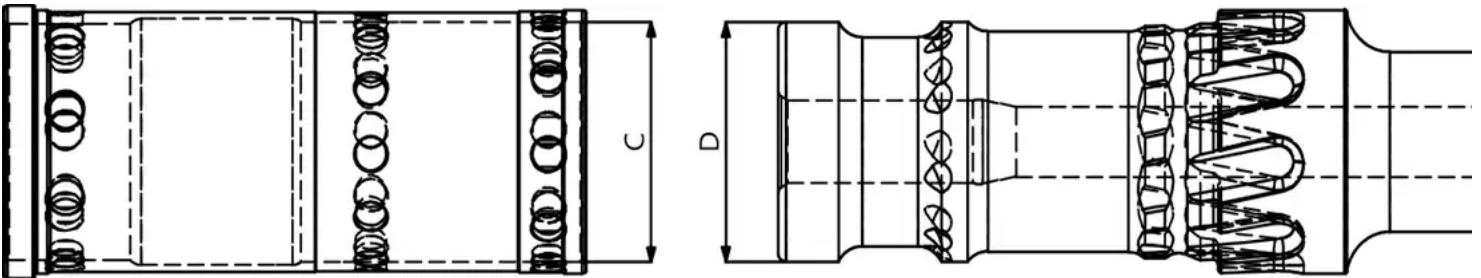

### Distributor Probe / Piston ID Clearance

Part	New Dimension		Discard Clearance
Distributor Probe OD	F	1.84"	greater than or equal to 0.010"
Piston ID	E	1.85"	

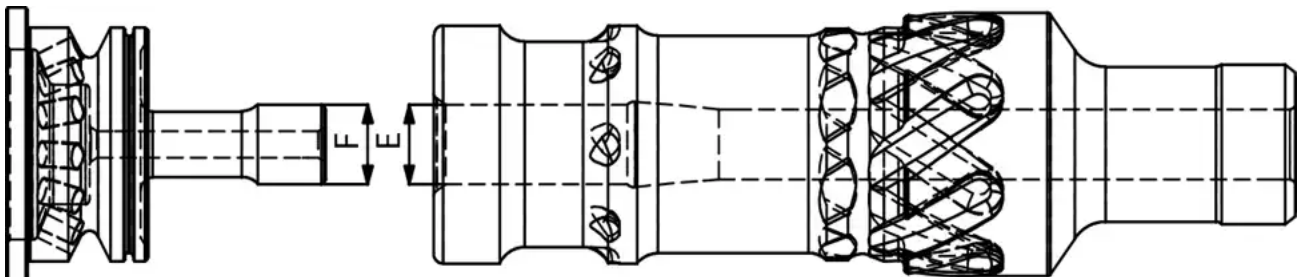

### Bearing - Piston OD Clearance

Part	New Dimension		Discard Clearance
Bearing ID	H	3.19"	greater than or equal to 0.010"
Piston OD	G	3.18"	

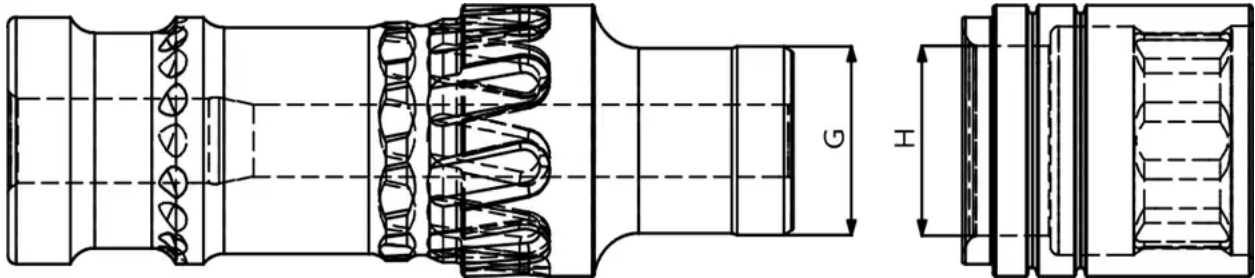

### External Wear

Description	Wear Limit
Wear Sleeve Reverse Dimension	6.93"
Wear Sleeve Discard Dimension	6.85"
NOTE: Chuck should be replaced when wear transfers to wear sleeve.	