

► Nova 5 " Hammer IR350 Service Log ◀

Hammer Service Log



WEAR SLEEVE / PISTON CLEARANCE

Part	New Dimension		Discard Clearance
Wear Sleeve	A	3.996" (101.5mm)	≥0.010" (0.25mm)
Piston O.D	B	3.991" (101.38mm)	

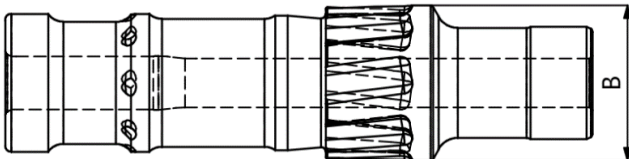
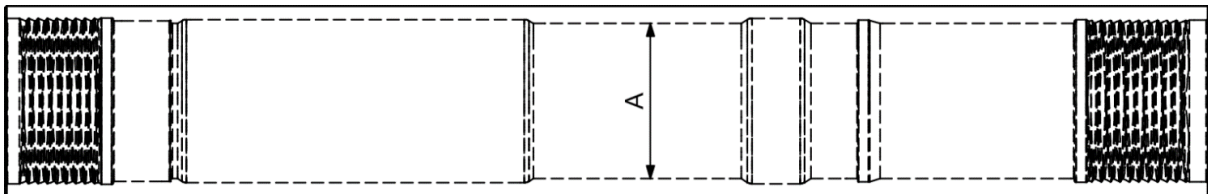

INNER CYLINDER / PISTON CLEARANCE

Cylinder I.D	C	3.547" (90.1mm)	≥0.010" (0.25mm)
Piston O.D	D	3.542" (89.98mm)	

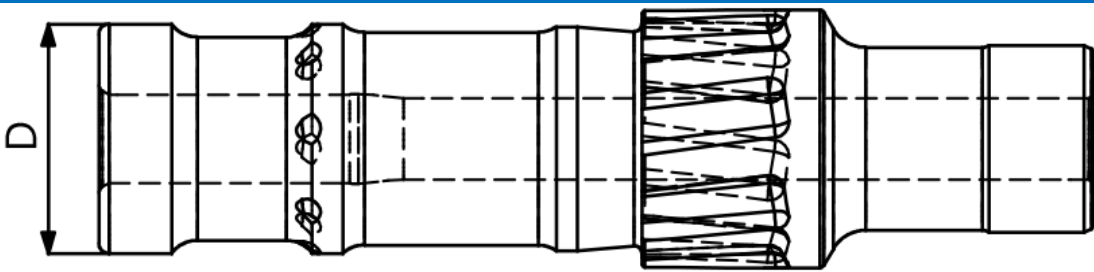
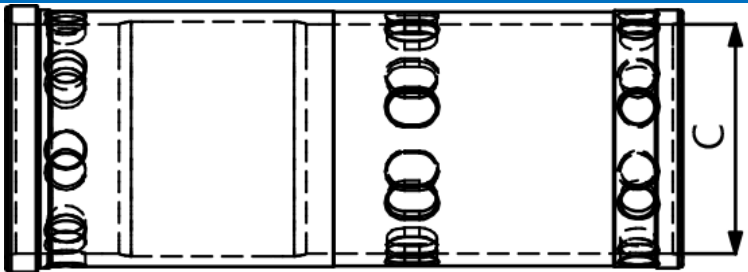

DISTRIBUTOR PROBE / PISTON ID CLEARANCE

Distributor Probe O.D	F	1.358" (34.5mm)	≥0.010" (0.25mm)
Piston I.D	E	1.368" (34.75mm)	

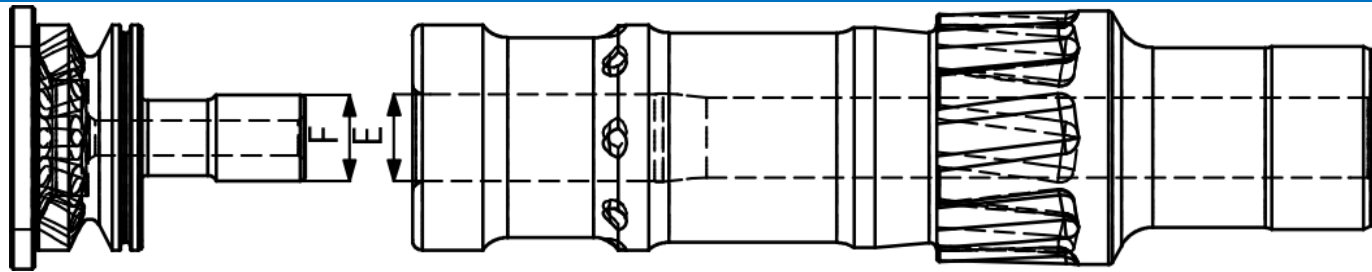

Bearing / PISTON OD CLEARANCE

Bearing I.D	H	2.892" (73.45mm)	≥0.010" (0.25mm)
Piston O.D	G	2.882" (73.2mm)	

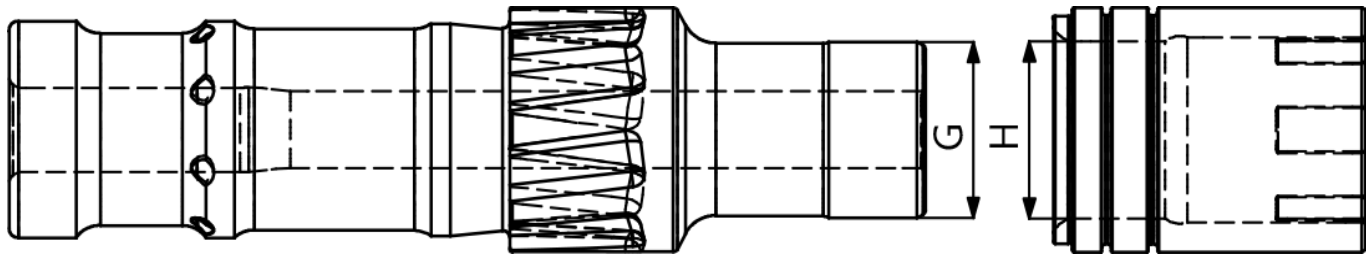

note.

1. Chuck should be replaced when wear transfers to wear sleeve.