

► Nova 8" Hammer QL80 Service Log ◀

Hammer Service Log



**WEAR SLEEVE / PISTON CLEARANCE**

Part	New Dimension		Discard Clearance
Wear Sleeve	A	5.925" (150.5mm)	≥0.010" (0.25mm)
Piston O.D	B	5.92" (150.38mm)	

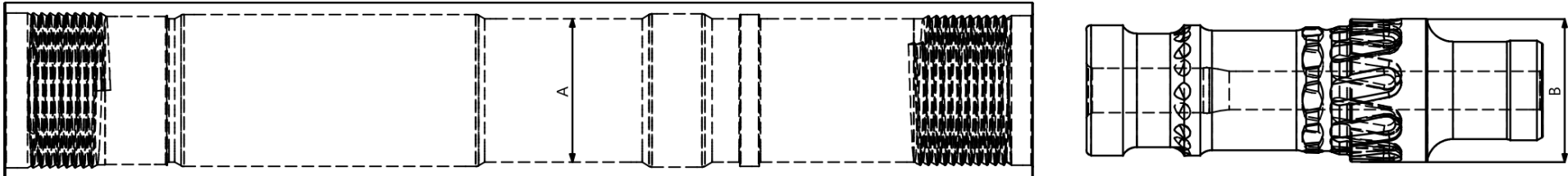

**INNER CYLINDER / PISTON CLEARANCE**

Cylinder I.D	C	5.394" (137mm)	≥0.010" (0.25mm)
Piston O.D	D	5.389" (136.87mm)	

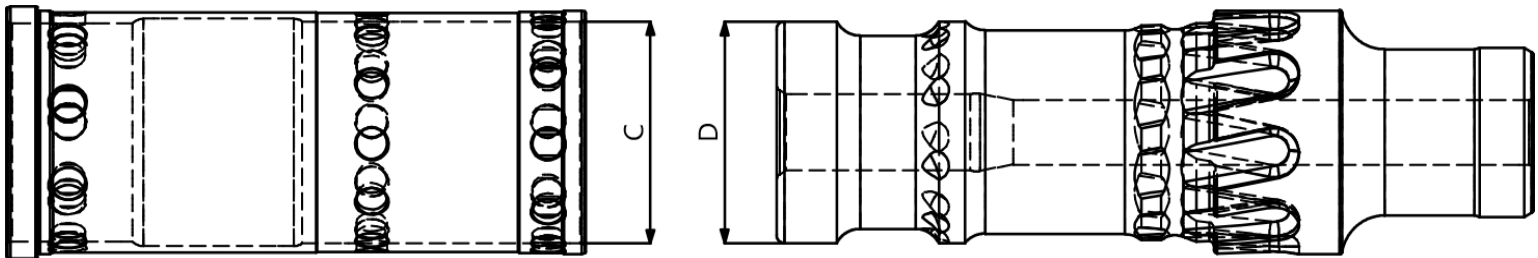

**DISTRIBUTOR PROBE / PISTON ID CLEARANCE**

Distributor Probe O.D	F	1.842" (46.8mm)	≥0.010" (0.25mm)
Piston I.D	E	1.85" (47.0mm)	

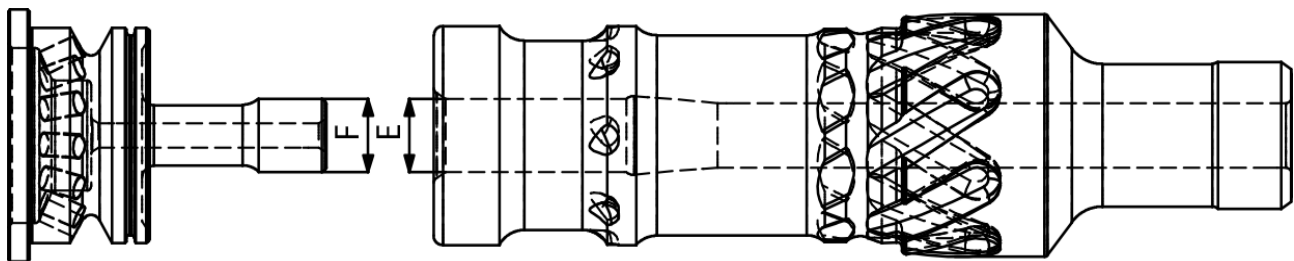

**Bearing / PISTON OD CLEARANCE**

Bearing I.D	H	4.134" (105mm)	≥0.010" (0.25mm)
Piston O.D	G	4.124" (104.75mm)	

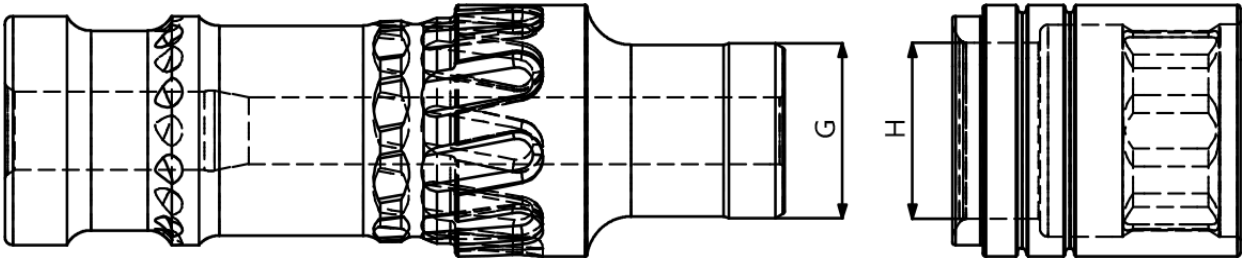

**note.**

1. Chuck should be replaced when wear transfers to wear sleeve.